

OSHTEMO TOWNSHIP
TEXAS TOWNSHIP

32
5 4

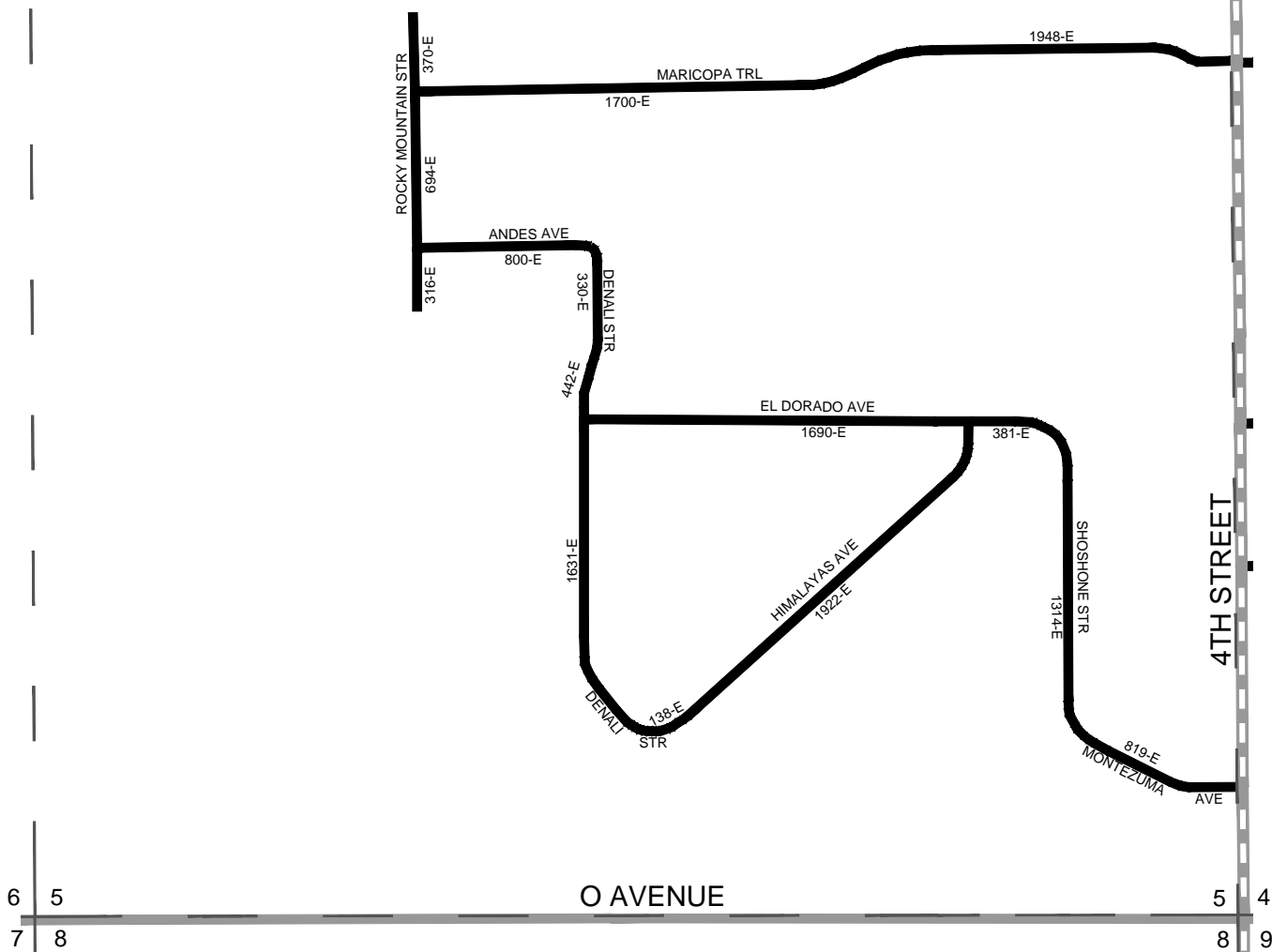
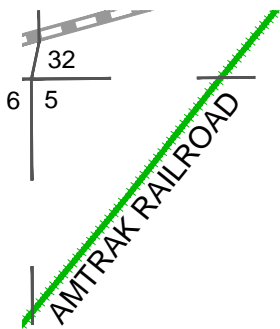

6 5
7 8

O AVENUE

5 4
8 9

LEGEND

- SECTION LINE
- CORPORATE LIMITS
- EDGE OF WATER
- RAILROAD
- STATE TRUNKLINE
- COUNTY PRIMARY
- COUNTY LOCAL
- MILEAGE REPRESENTED ON TOWNSHIP OVERVIEW SHEET
- COUNTY LOCAL MILEAGE REPRESENTED ON THIS SHEET

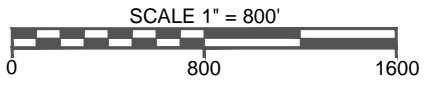
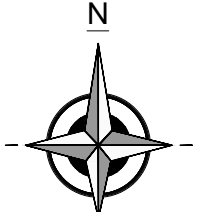
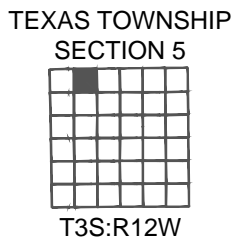

LOCAL ROAD SYSTEM TOTAL
FEET 14,495 EQUALS 2.75 MILES